

Thank you for purchasing the www.crafthub.io Active Suspension Conversion kit



Active Suspension Conversion Kit For Yokomo YD-2 E series /S series

This is a suspension Conversion kit. To use SuperScale2k20 SS Unit, This kit can use the full potential of the SS unit instantly. And you can get the realistic motion for your Yokomo YD-2chassis.

Physical kit

All of the parts are made with Color Fabb HT automobile grade tough and durable material.
*without body mounts, etc.

Data kit

You have to print out all parts by yourself. The material you should use ABS or ColorFab HT, etc. otherwise the parts don't have enough rigidity. PLA is not recommended.

Future

- Come with All of the parts that you use SuperScale2K20 SS unit.
- Design for Yokomo YD-2 E series /S series
- Active suspension and conventional suspension hybrid.
- Simple and reliable, easy to swap design.
- Fully compatible original suspension geometry

What is contained in this kit?

Parts list of this kit

	Name	note	
1	FrontStruttower		
2	FrontstrutArms		
3	RearStruttower	E or S	
4	RearStrutArm		
5	FixScrew	M3*12	4
6	FrontServoBackle		
7	Rear ServoBackle		
	Screw etc kit		
8	servo FixScrew	M3*10 M3*6	14(2)
9	TaperWasher	orange Alu	4
10	Screw	M3*8	4
11	SqueaNut	M3	2
12	M3 Nut	M3	3
13	Ballend	Yokomo4.8	4
14	ballStud	Tamiya	1set
15	TurnBackle	Yokomo4.8	4
16	Rodend	4.8	8
17	HardSpring RED	Tamiya	1set
18	HardSprinh Gray	Tamiya	1set
20	Accessory kit		
21	Gyromount	PLA Only E kit	1
22	servo Hone	PETG	4
23	SSunitMount	PLA Only Ekit	1
28	Body mount	TPU	2
	Fixscrew	M3*10	4

RED mark up parts are not coming with Data kit. You have to buy those parts by yourself.

What you need without this kit

- SuperScale2k20 SS unit
- Suitable servo *4
- 10A UBEC
- 3M Double Side Tape

Digital servo required

For Drift Car, Don't need so much torque. 5-10kg may enough, However, metal geared servo is required.

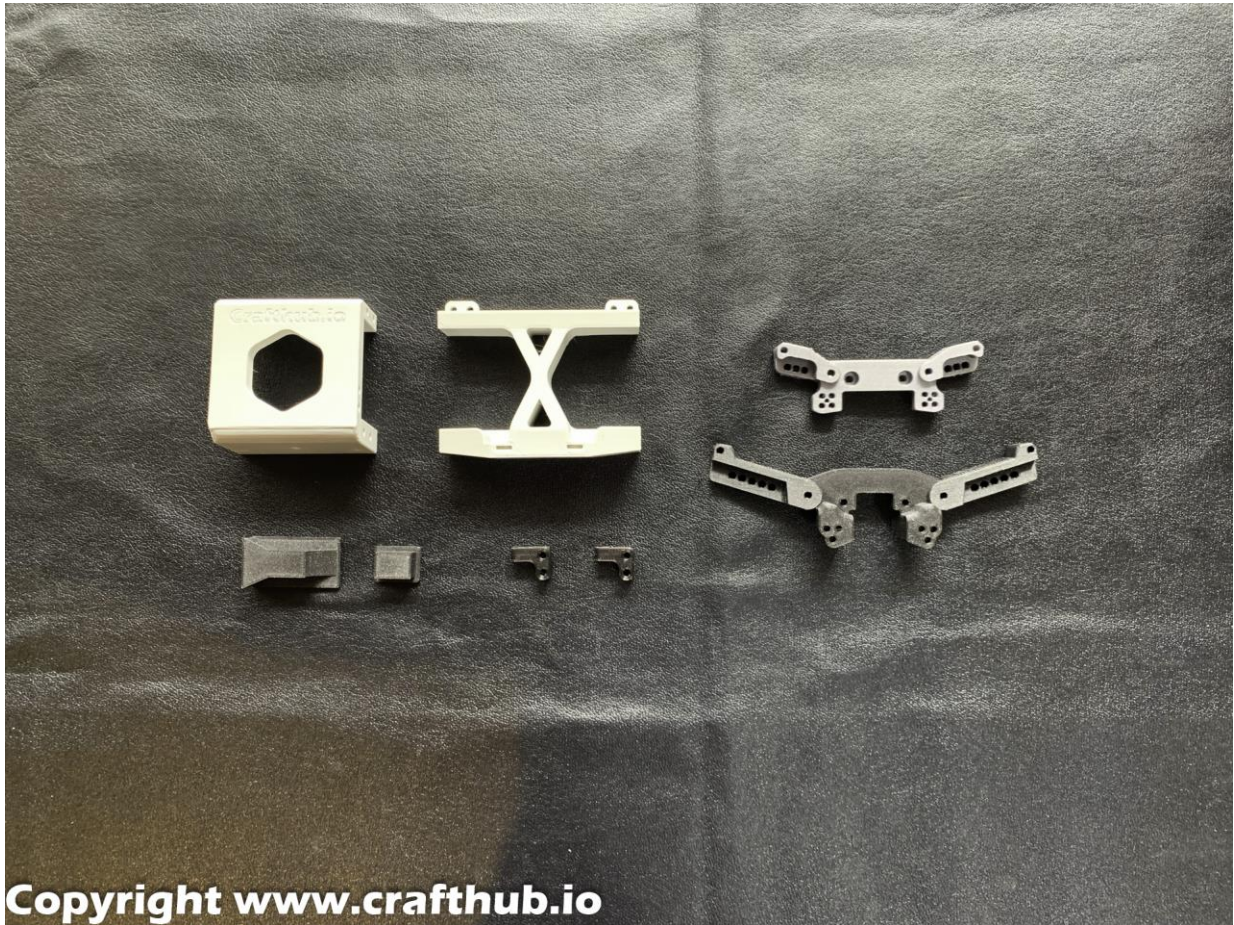

1, Installation

Use M3 screw, M3 Nut and gently insert to the M3 Nut position.



Copyright www.crafthub.io

Use the screw to pull the nut into M3 Nut position

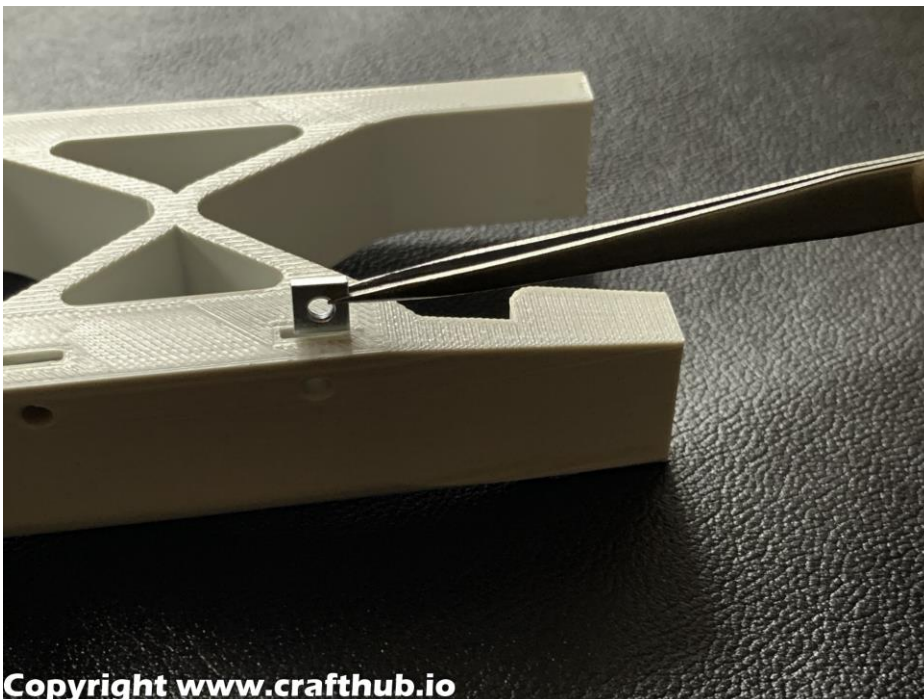

Copyright www.crafthub.io

Insert Square nut on slot.

2, High Torque Servo installs



Use M3*10 CapScrew(PartsNo13) to screw servos to chassis mount brackets.

The mount screw hole size is 2.8mm and optimize the tolerance for M3 Screw.
The Servo's output shaft should be **on the side closest to chassis mount holes.**



Front Servo bracket

Only this part, you have to use M3*6 screw, instead of M3*10 screw to avoid not to interfere with fixing screw.



3, Remove the bumper

The Bumper fix screw is used to fix a servo Bracket

4, Swap the Strut tower bar(Front)

Front Strut (Remove the original Strut Tower)

Remove the ball end and fix it in a correct position

Use a Tamiya Fluorine coated Stabilizer Ball connector set For the front, use this one.(partsNo14)



Assemble the front Strut tower by adding M3*15 screws for the front. Do not over tighten. Check for minimum play and movement.

The assembled strut tower **needs a little bit friction**. If this part is too loose, the SS's multiplier value can't increase, and serious oscillation will occur and won't stop. However, **regular suspension linkage parts have to always be very smooth**.

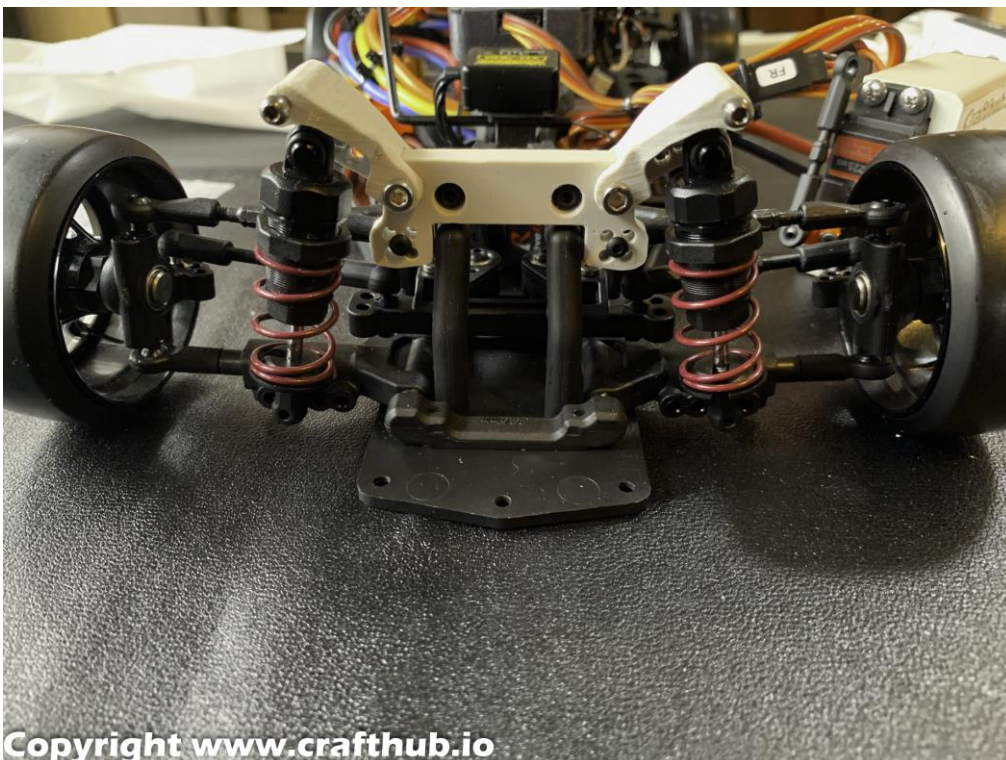

Copyright www.crafthub.io

Check Ball connector position.

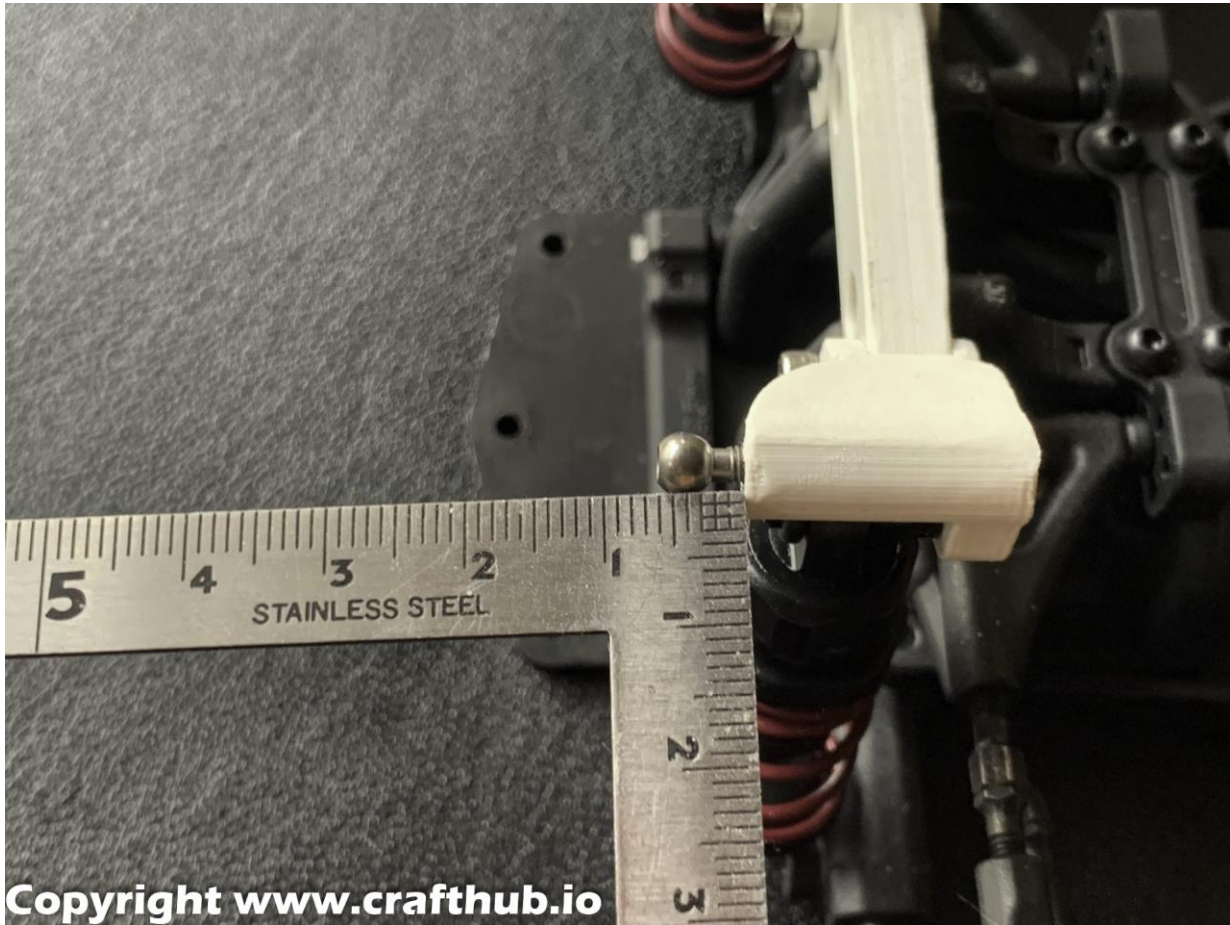

5, Swap the Strut tower bar (Rear)

Swap the original Strut Tower



Copyright www.crafthub.io

For YD-2S



Copyright www.crafthub.io

For YD-2E

Assembling the Rear Strut tower: (Assembled)

Using M3*12 screw for the Rear. (Do not over tighten)

Check minimum play (The arms should move easily.)

The assembled strut tower **needs a little bit friction**. If this part is too loose, the SS's multiplier value can't increase, and serious oscillation will occur and won't stop. However, **regular suspension linkage parts have to always be very smooth**.

Use a Tamiya Fluorne coated Stabilizer Ball connector set For the Rear , use this one.(partsNo17)

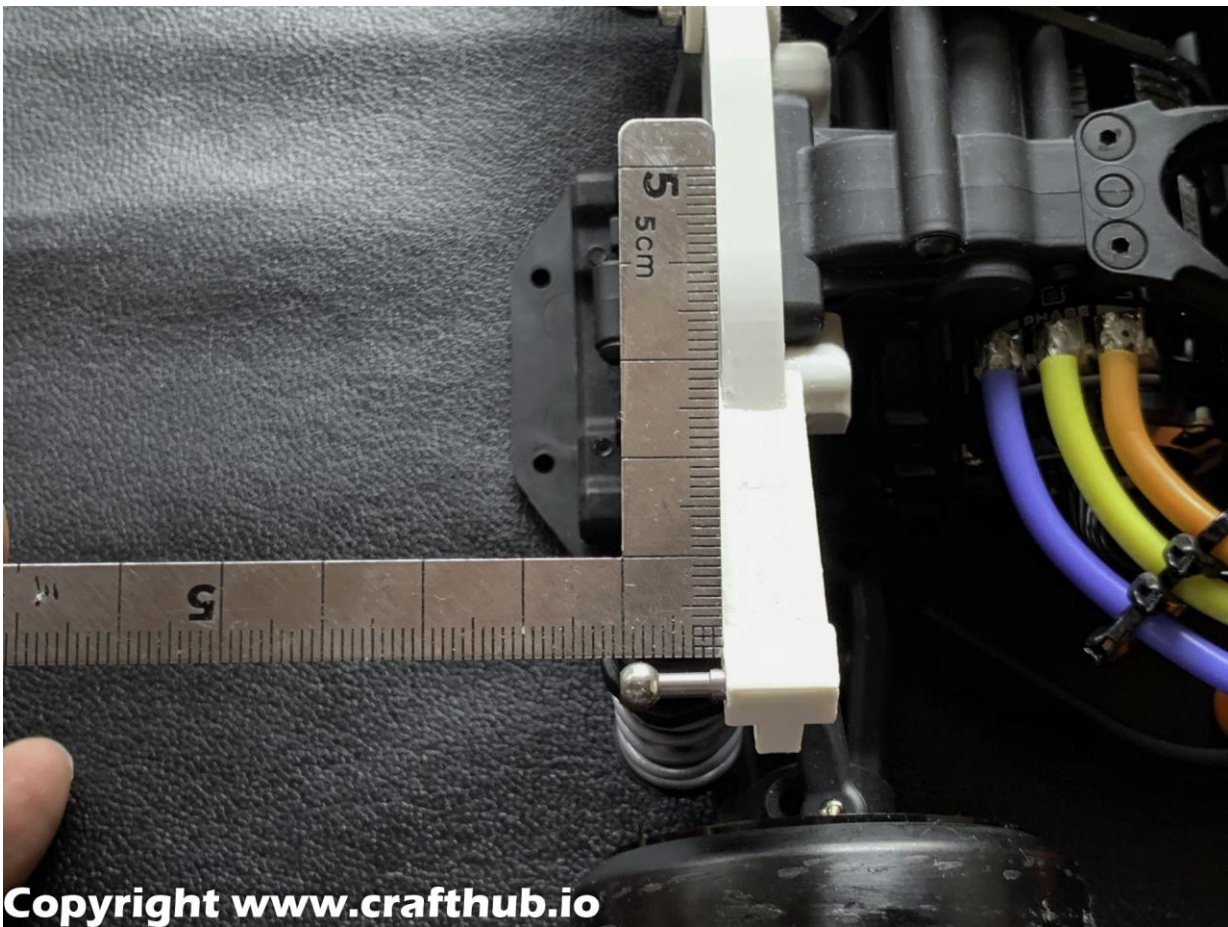

6, Mounting the servo holder

Frontside

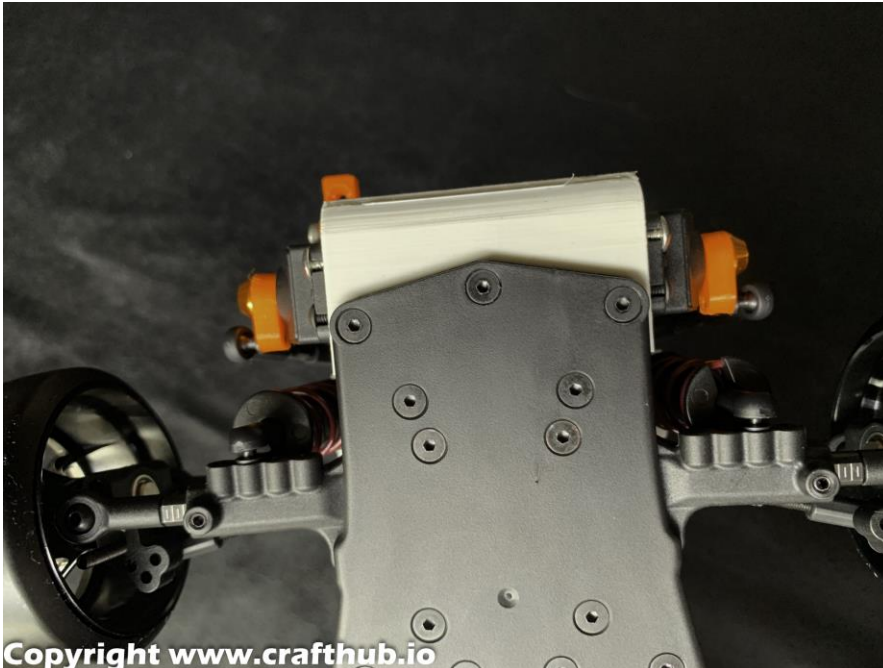

Copyright www.crafthub.io

Use the screw that Yokomo original Bumperfix used.

The *Front servo holder has 3 screws. The rear servo holder has 2 screws.

Rear Side



Copyright www.crafthub.io

Remove the original bumper and replace to Servo holder.

About the Rear screw. Use the screw that MST original used.



7, Initial setup of SS unit

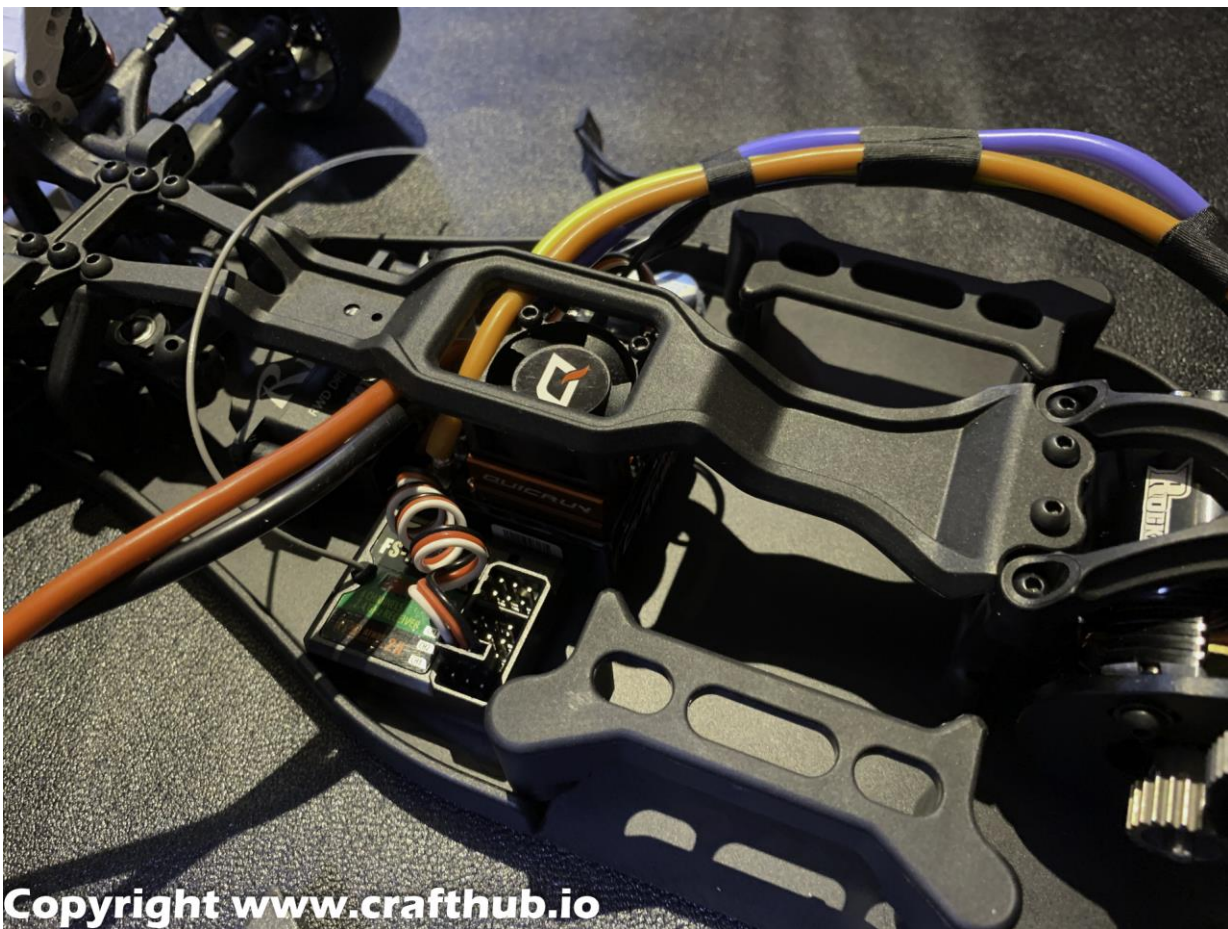

Copyright www.crafthub.io
Use Double side tape and fix on Upperdeck

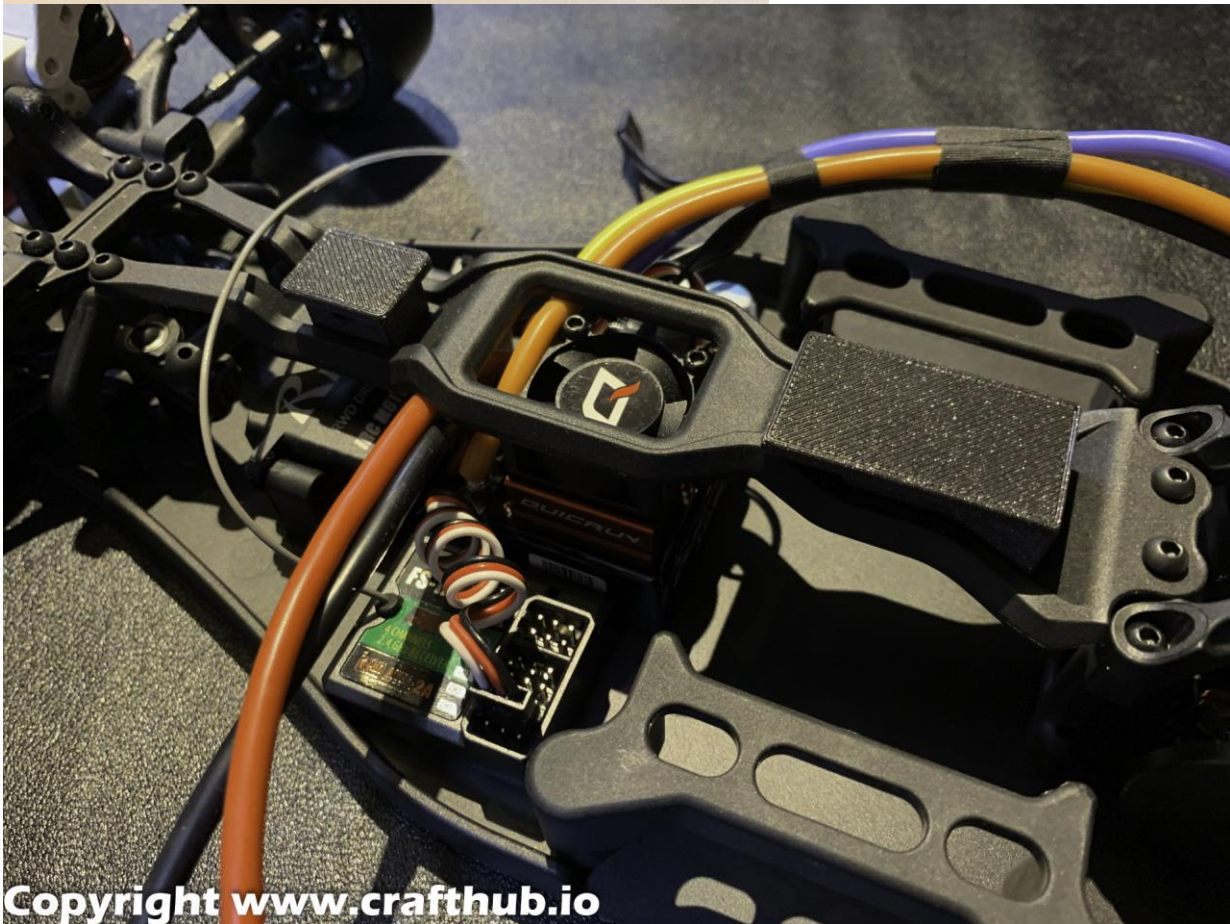
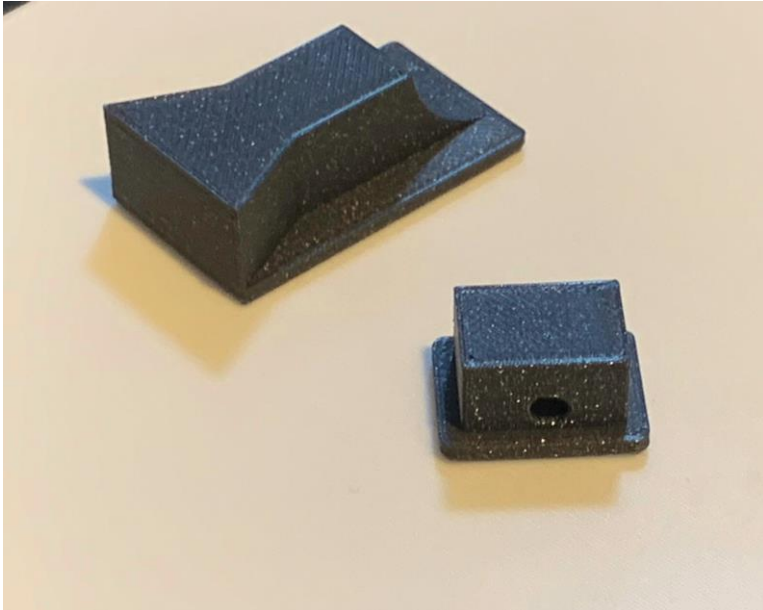

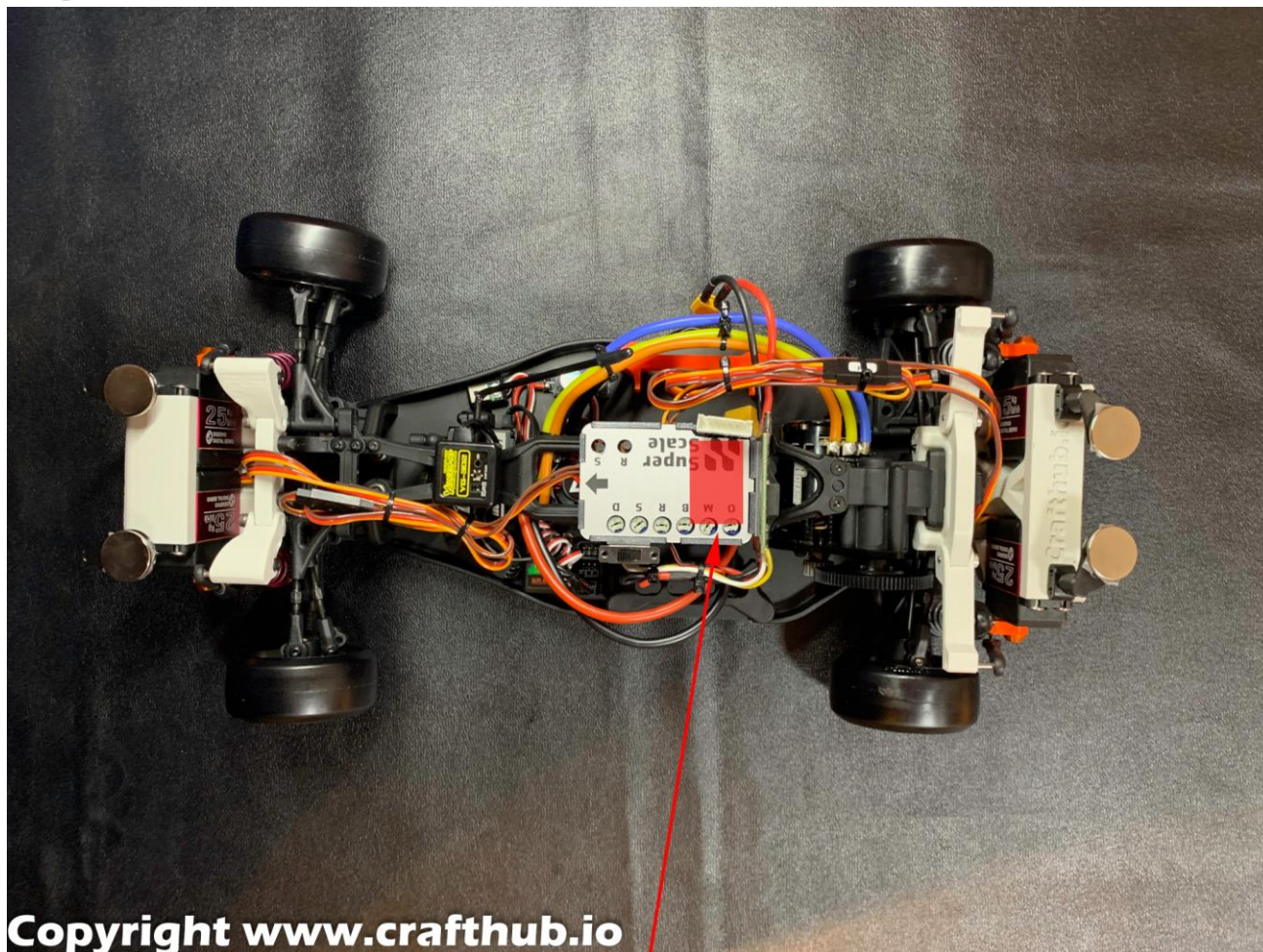

Be aware of the gyro sensor position in SS unit

Firmware needed from SuperScale2k20

SUPERSCALE_V1.2.ino.hex

***this firmware is pre installed**

Steering Gyro mount hole is used for antenna hold.

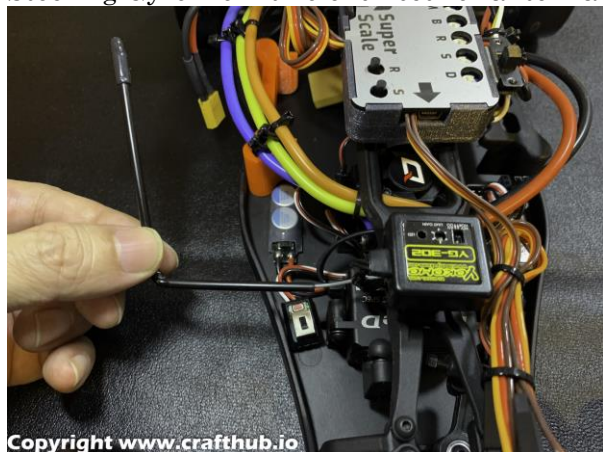



8, How to setup SS unit

You need to install Arduino configuration software. Please download from the link below.
<https://www.arduino.cc/en/Main/Software>

You may download Arduino IDE software for your suitable platform. MacOS or Win

Step 1

First connect the SS unit to the PC and set the offset to 0.

Next set BALANCE to 50.

The servo's neutral PWM value is almost 1500

FLpos 1500

RLpos 1500

*you should provide the power for SS Unit cause USB doesn't provide enough power to move the servo neutral position.

Step2

Check all of 4 servo is neutral position, and then Set the servo horn like this.



Copyright www.crafthub.io

Servohorn and endball fix with M3x8 cap screw

This horn has tapered servo shaft connection, so any spline servo can perfect fit for this servo horn. so this servo horn material is PETG.

Use with Tapered washer like the photo, it contains the kit (Parts No9).

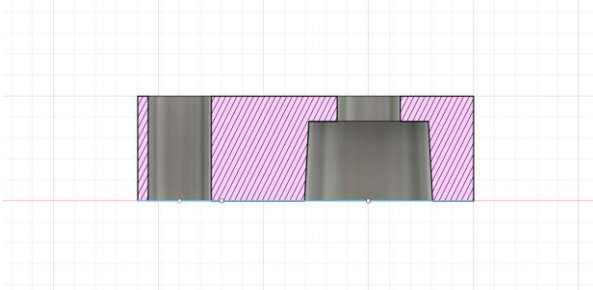

Servohorn cut image

Step3

Adjust The turnbuckle length, and then connect servo and Strut arm.



Parts No16

Front and Rear Rod Length

Front Rod length



Front=41mm

RearRodLength



Rear=39.3mm

All about physical setup is done, please test the sample setting value.

Spring preload

Front



4mm

Rear



1mm

Yokomo YD-2 sample setup value

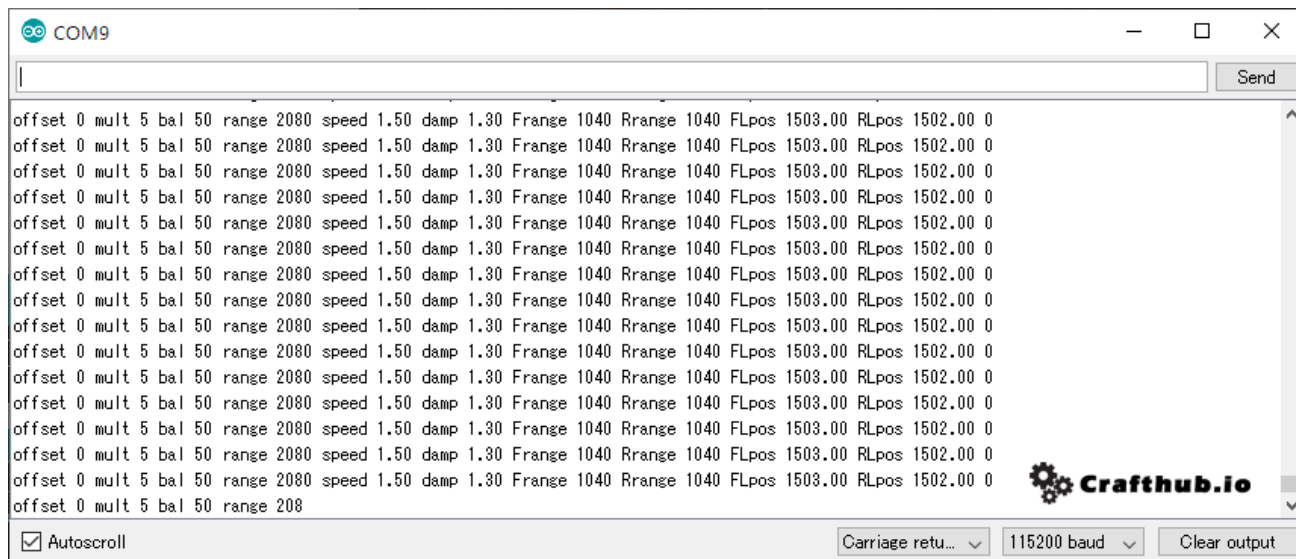

The screenshot shows a serial terminal window titled "COM9" with a "Send" button. The terminal displays a list of 16 lines of setup values for the Yokomo YD-2. The values are repeated for each of the 16 lines. The last line is "offset 0 mult 5 bal 50 range 208". The terminal also has a "Crafthub.io" logo in the bottom right corner. At the bottom of the window, there are checkboxes for "Autoscroll" (checked), "Carriage return" (set to "Carriage return"), "Baud rate" (set to "115200 baud"), and a "Clear output" button.

```
offset 0 mult 5 bal 50 range 2080 speed 1.50 damp 1.30 Frange 1040 Range 1040 FLpos 1503.00 RLpos 1502.00 0
offset 0 mult 5 bal 50 range 2080 speed 1.50 damp 1.30 Frange 1040 Range 1040 FLpos 1503.00 RLpos 1502.00 0
offset 0 mult 5 bal 50 range 2080 speed 1.50 damp 1.30 Frange 1040 Range 1040 FLpos 1503.00 RLpos 1502.00 0
offset 0 mult 5 bal 50 range 2080 speed 1.50 damp 1.30 Frange 1040 Range 1040 FLpos 1503.00 RLpos 1502.00 0
offset 0 mult 5 bal 50 range 2080 speed 1.50 damp 1.30 Frange 1040 Range 1040 FLpos 1503.00 RLpos 1502.00 0
offset 0 mult 5 bal 50 range 2080 speed 1.50 damp 1.30 Frange 1040 Range 1040 FLpos 1503.00 RLpos 1502.00 0
offset 0 mult 5 bal 50 range 2080 speed 1.50 damp 1.30 Frange 1040 Range 1040 FLpos 1503.00 RLpos 1502.00 0
offset 0 mult 5 bal 50 range 2080 speed 1.50 damp 1.30 Frange 1040 Range 1040 FLpos 1503.00 RLpos 1502.00 0
offset 0 mult 5 bal 50 range 2080 speed 1.50 damp 1.30 Frange 1040 Range 1040 FLpos 1503.00 RLpos 1502.00 0
offset 0 mult 5 bal 50 range 2080 speed 1.50 damp 1.30 Frange 1040 Range 1040 FLpos 1503.00 RLpos 1502.00 0
offset 0 mult 5 bal 50 range 2080 speed 1.50 damp 1.30 Frange 1040 Range 1040 FLpos 1503.00 RLpos 1502.00 0
offset 0 mult 5 bal 50 range 2080 speed 1.50 damp 1.30 Frange 1040 Range 1040 FLpos 1503.00 RLpos 1502.00 0
offset 0 mult 5 bal 50 range 2080 speed 1.50 damp 1.30 Frange 1040 Range 1040 FLpos 1503.00 RLpos 1502.00 0
offset 0 mult 5 bal 50 range 2080 speed 1.50 damp 1.30 Frange 1040 Range 1040 FLpos 1503.00 RLpos 1502.00 0
offset 0 mult 5 bal 50 range 2080 speed 1.50 damp 1.30 Frange 1040 Range 1040 FLpos 1503.00 RLpos 1502.00 0
offset 0 mult 5 bal 50 range 208
```

This is the start value to set up the active suspension
 More detail, please refer to SS unit manual.

Front Suspension Setting

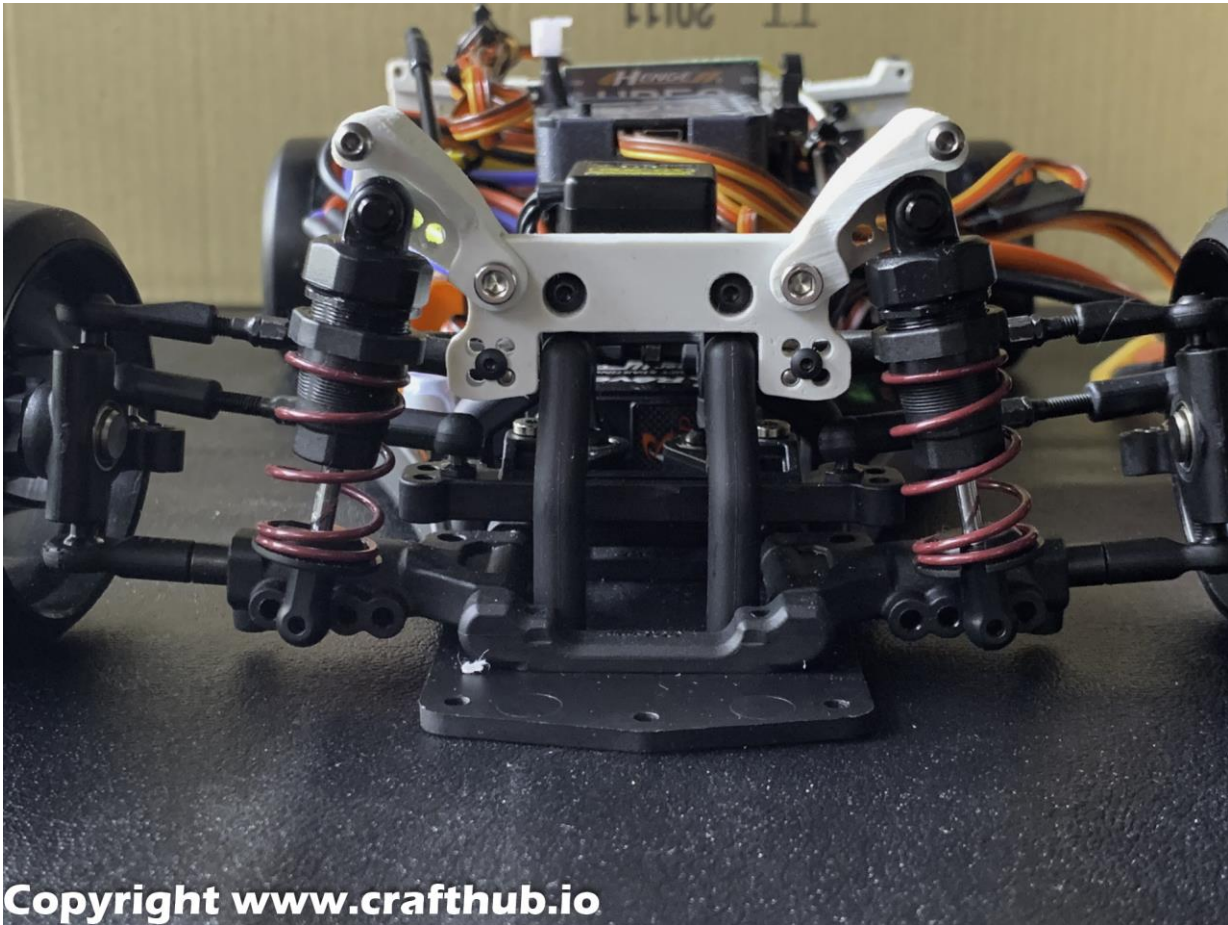

Copyright www.crafthub.io
Change the Front Spring to Red(partsNo19) .

Rear Suspension Setting

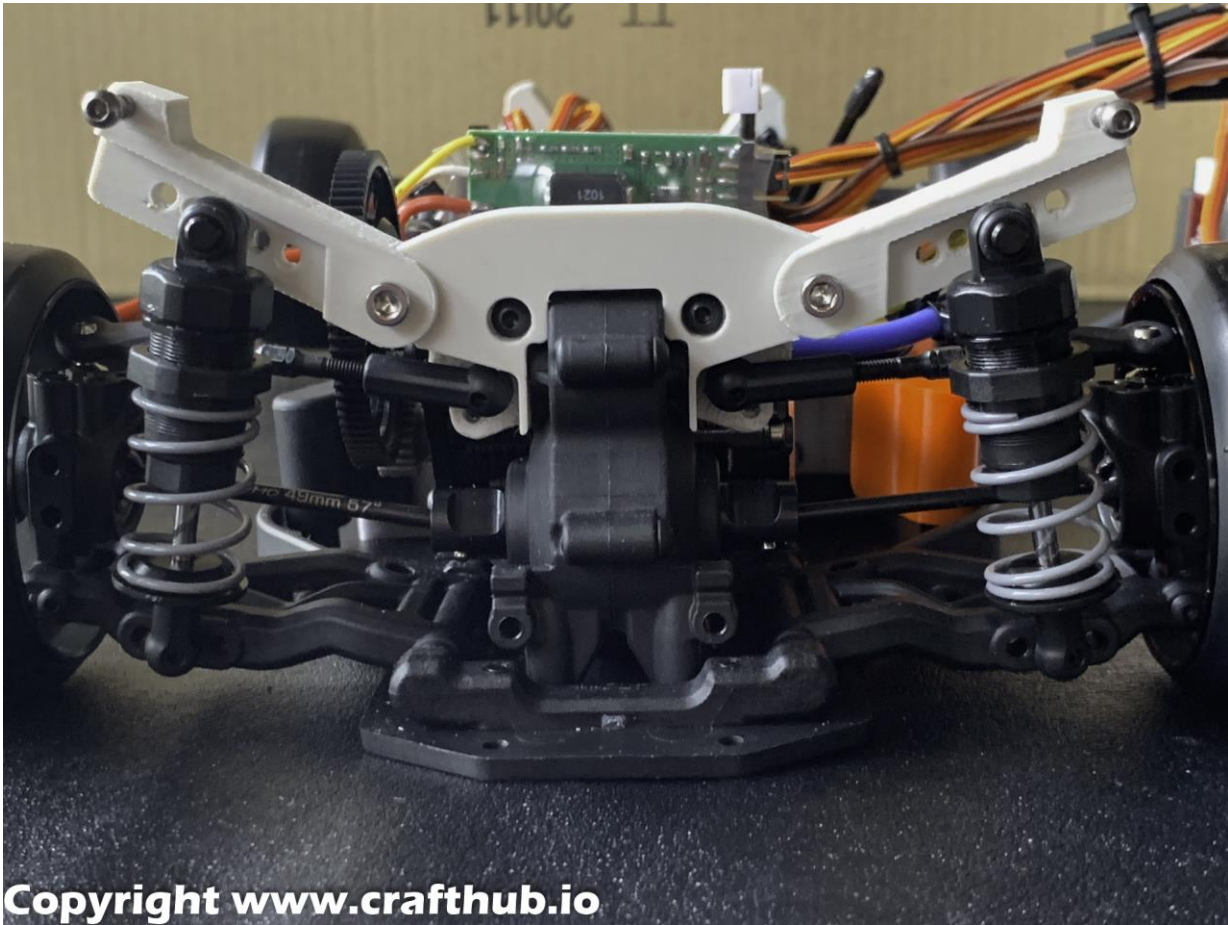

Copyright www.crafthub.io
Change the Front Spring to Gray (partsNo20).

It will be better to change more high viscosity dumper oil.

Body mount kit



Copyright www.crafthub.io

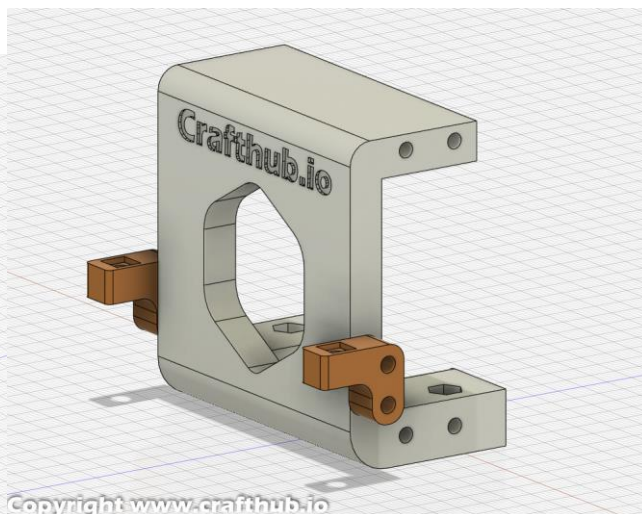

Copyright www.crafthub.io

Body mount post parts have a compatibility with Yokomo Genuine Body mount rod

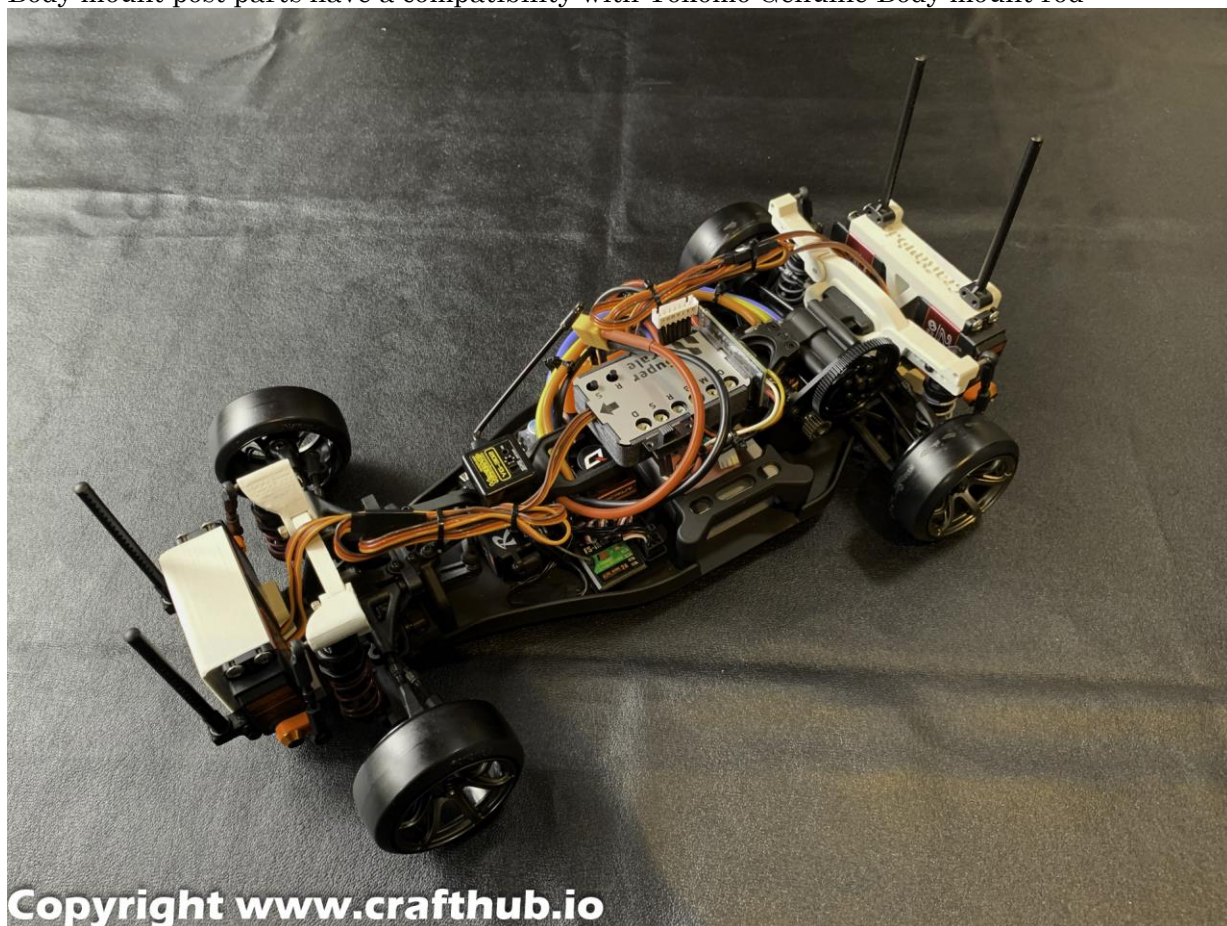

Copyright www.crafthub.io

You can use your suitable third party body mount. Or make a hole on body and fix the body use Body pin.

**Disclaimer**

Do not use this file for commercial purpose without any permission.

This model was made FDM 3Dprinter, the parts have some additive markings, however, no problem for those parts function.

We use ColorfabbHT firmament

<https://colorfabb.com/colorfabb-ht-tritan>

If you have any question, please contact is via a form.

<https://www.crafthub.io/contact-us/>

Crafthub.io kay Hirano

<http://www.crafthub.io>

Instagram: @crafthub.io

Youtube: https://www.youtube.com/channel/UC5s76d53JjdKf_krIeUo6MQ/videos